

# FEATURES & FINISHES



## GENERAL SUITE

- Solid core entry door with security view-hole.
- 9' high ceilings with smooth plaster finish in most areas, not including bulkheads and dropped ceilings when required for mechanical purposes such as kitchen and bath exhausts and heating and cooling ducts.
- Choice of designer-selected laminate flooring in living/dining areas, foyer, kitchen and bedrooms, as per builder's standard samples.
- Contemporary baseboards, door frames and casings.
- Black metal door hardware.
- Wire shelving in all closets.
- Insulated double-glazed, aluminum windows.
- White painted drywall walls (except where tile occurs).
- One-piece stacked brand name washer/dryer with exterior venting.
- Individually controlled heating and cooling.
- White "decora" switches and outlets.
- Ontario Building Code mandated emergency voice communications system, in-suite sprinkler fire protection system, smoke, heat and carbon monoxide detectors where applicable in each suite.
- Pre-wired outlets for television, telephone and/or internet connections in living room, bedroom(s) and den, as per plan.

## KITCHENS

- Designer selected two-tone cabinetry and contemporary hardware.
- Quartz kitchen countertop, from builder's standard samples.
- Porcelain tile backsplash, from builder's standard samples.
- Single bowl stainless steel under-mounted sink with single handle, single hole, black pull-down faucet.
- Surface-mounted, black track lighting fixture.
- Integrated European-style fridge, integrated dishwasher, separate stainless steel cooktop and stainless steel wall oven, stainless steel built-in microwave, and under-cabinet hood vent vented to the exterior.

## BATHROOMS

- Custom-designed vanity with quartz countertop and backsplash and under-mount sink.
- Designer selected black framed mirror with integrated lighting.
- Black single hole faucet.
- Two-piece modern style white toilet.
- Units with 1 bathroom have a soaker tub with black tub filler, valve and showerhead.
- Units with 2 bathrooms have a shower with black framed glass fixed partition and a black valve and showerhead in the ensuite and a soaker tub with black tub filler, valve and showerhead in the second bath (all as per plan).
- Porcelain tile flooring and tub/shower surround.
- Black accessory package including towel bar and paper holder.
- Exhaust fan vented to the exterior.

## THE COTTAGE COLLECTION UPGRADES

**For a limited time,  
suites from The Cottage  
Collection are eligible for  
\$20,000 in upgrades,  
including:**

- Designer selected Shaker-style cabinetry in kitchens.
- Electric fireplace with custom millwork surround and component nook in living room.
- Custom-designed wood feature wall in main bedroom.
- Wood-inspired porcelain tile shower walls in ensuite.
- Matching wood-inspired vanity porcelain feature tile wall in ensuite.





## THE COAST CLUB

- 1. CARDIO & STRENGTH TRAINING
- 2. SPIN STUDIO
- 3. STRETCH AREA
- 4. STRENGTH TRAINING
- 5. FUNCTIONAL TRAINING
- 6. YOGA STUDIO
- 7. PRIVATE CHANGE ROOMS & STEAM ROOMS

## ADDITIONAL GROUND FLOOR AMENITIES

- 8. THE WOODBINE COWORKING SPACE
- 9. THE UPPER LOUNGE
- 10. THE BRIDGE LOUNGE

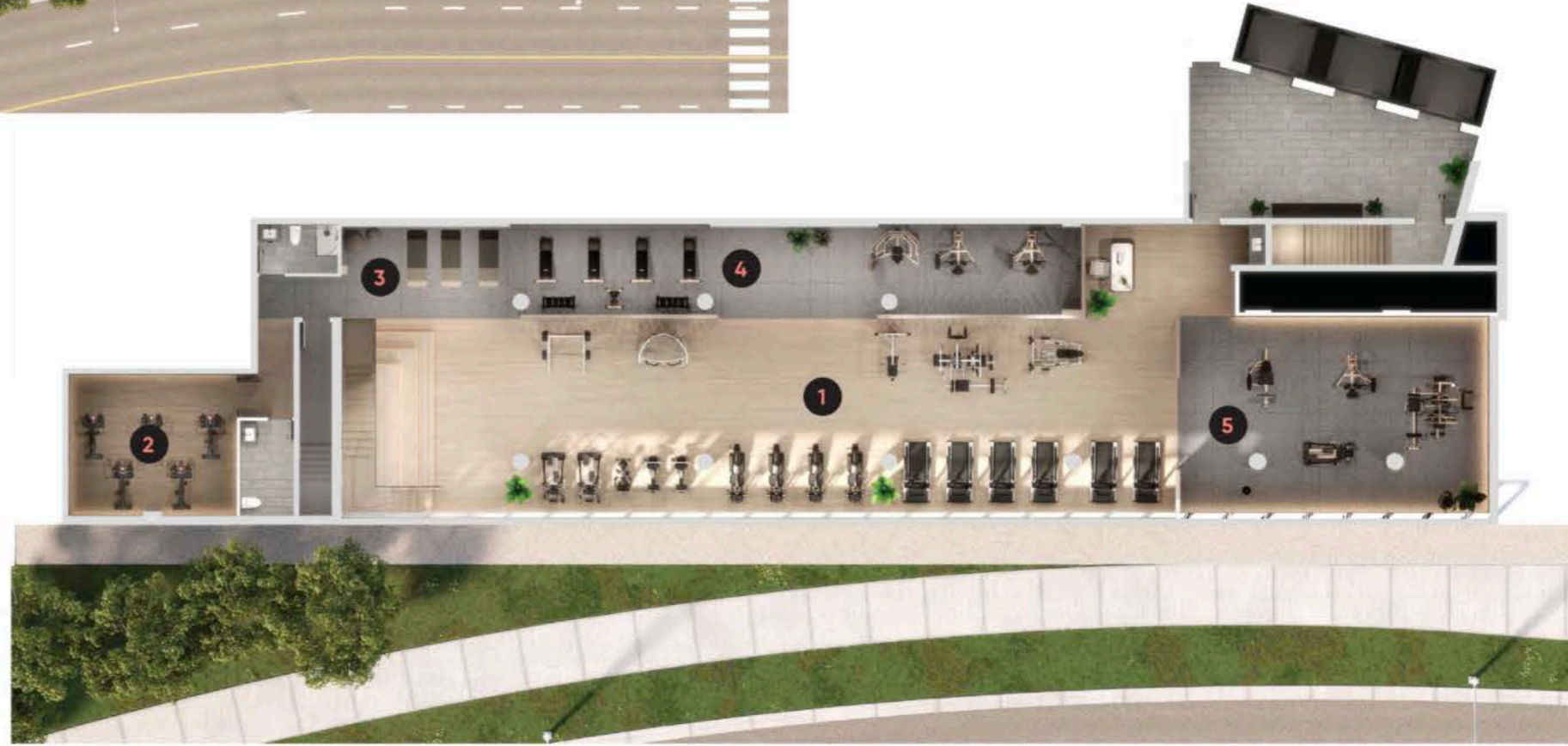

# LEVEL 8 & 9 AMENITIES

- 1. THE SKY CLUB
- 2. THE SKY CLUB TERRACE LOUNGE
- 3. THE SKY CLUB TERRACE OUTDOOR BBQ & DINING AREA
- 4. THE SKY CLUB TERRACE SUN DECK
- 5. DOG RUN

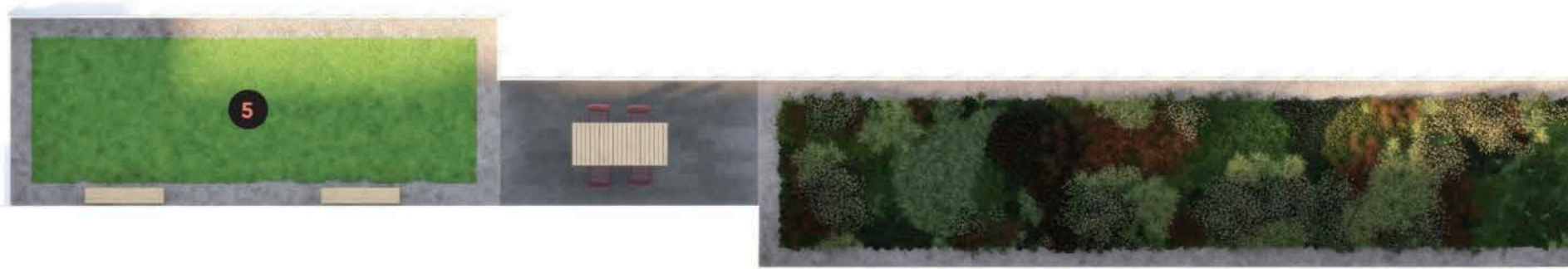

## LEVEL 9



## LEVEL 8